



The new generation of **PETKUS Gravity Tables G** has a state of the art aerodynamics and counterbalancing. Using the most modern simulation tools available the design of the table between the fans and the table top was optimized to produce a laminar air flow whose pressure and speed is consistent at all points on the table. This not only leads to optimized sorting results but also to higher performance levels. PETKUS Gravity Tables sort according to specific weight and are used wherever products with varying weights need to be sorted.

Key Properties:

- Variable vibration frequency
- Precise adjustment of the table angle on both planes
- Table top is quick and easy to change
- Electrical height adjustment
- Easy opening of the deck with gas springs
- Minimum vibration due to the new counterbalancing system
- Homogen air pressure and distribution due to the optimized aerodynamics

Applications:

- Seed processing of grain, corn, fine seeds, pulses, oilseeds, grass seeds, cottonseed
- Separation of impurities from lentils, peas, beans, coffee, peanuts, hazelnuts, and almonds in the food industry
- Separation of metals, plastic, rubber, wood, minerals

Options:

- Vibrating discharge conveyor for gentle transport of grains
- Touch-panel controlled vibrating feeder for poorly flowing products
- 5 decks with varying mesh size for different products
- 3 sizes of dedusting hoods (one-third, one-half or complete coverage)
- Buffer bin
- Operating platform

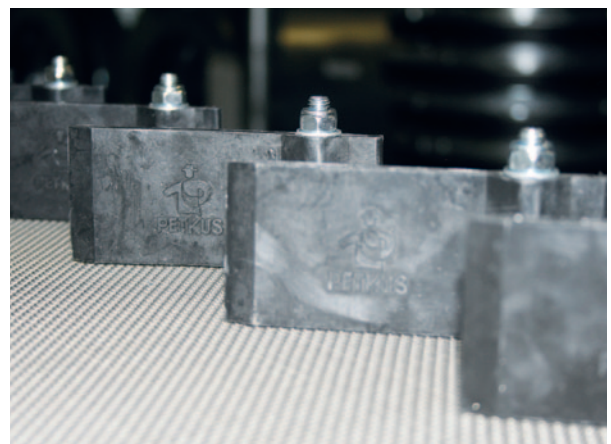

The newly designed flaps support the mechanical selection

Gravity Table Type G 20

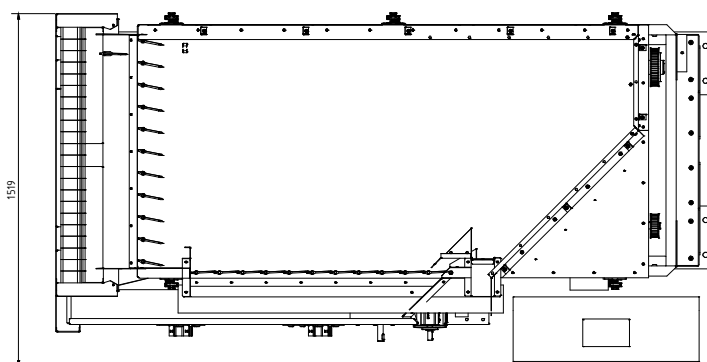
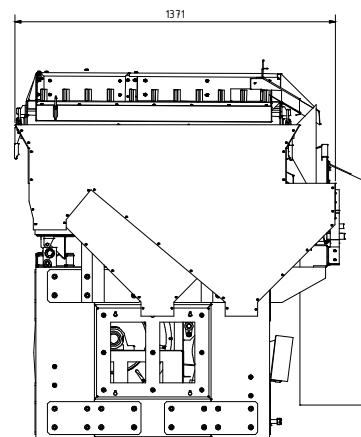
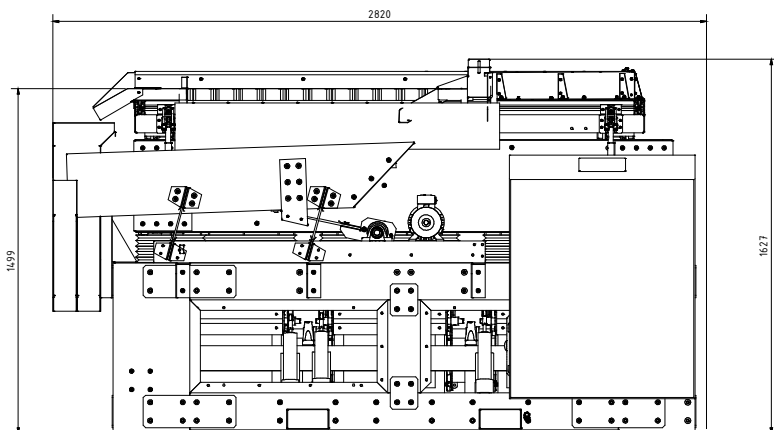

Technical Data		G 20
Capacity (Basis: wheat)	t/h	5
Capacity (Basis: maize / soybeans)	t/h	4
Capacity (Basis: clover seed)	t/h	1.3
Table size	mm	1 000 x 2 200
Excentric Drive	kW	1.5
Fan	kW	11
Discharge	kW	0.55
Air volume	m ³ /h	24 000
Length	mm	2 820
Width*	mm	1 371
Height	mm	1 499
Weight	kg	app. 2 000

* Overall / including switching cabinet and removable parts

Technical alteration reserved